



CONTACT

RED Partners

**Rob Hord
&**

**Bobby Edwards
Bobby@redpart.com
(704)909-2484**

www.redpart.com

Every effort has been made to ensure the accuracy of the information presented but no liability is assumed for errors or omissions. This offering is subject to prior sale, lease, change or withdrawal without prior notice and approval of owner.

Location: 8432 Plaza Road Ext
Charlotte, NC 28215

Parcel ID #'s: 10816623, 10816624, 10816625,
10816626, 10816627

Zoning: R-3

Acreage: ± 10.192

Asking Price: \$1,795,000

Description: Vacant land development opportunity. Seller willing to sell subject to rezoning allowing the purchaser the ability for a higher density development.



REAL
ESTATE
DEVELOPMENT
PARTNERS

Site Topography

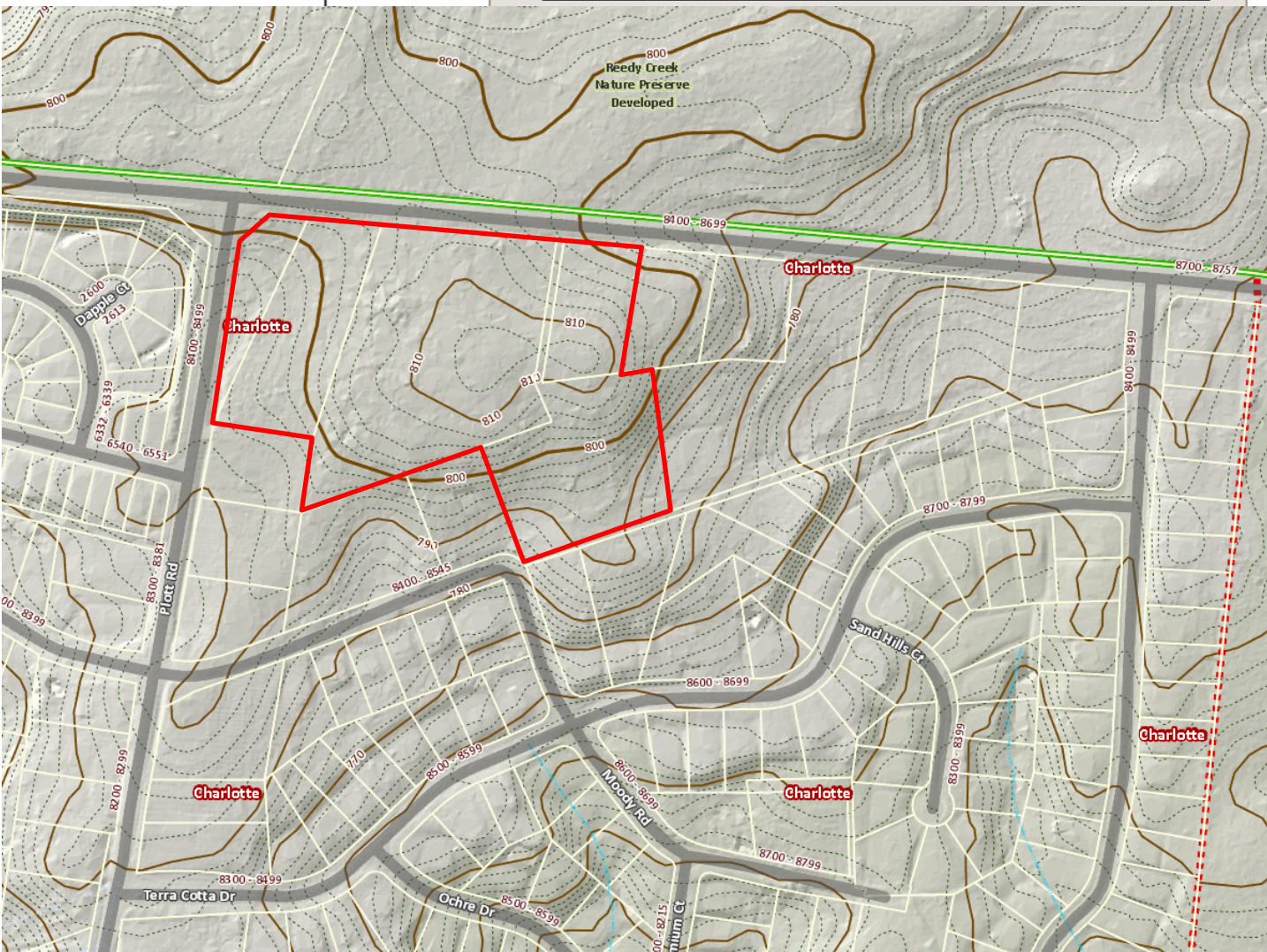

CONTACT

RED Partners

Rob Hord
&
Bobby Edwards
Bobby@redpart.com
(704)909-2484

www.redpart.com

8432 Plaza Road Ext.
Charlotte, NC 28215

Zoned R-3

± 10.192 acres

\$1,795,000 Asking Price

Every effort has been made to ensure the accuracy of the information presented but no liability is assumed for errors or omissions. This offering is subject to prior sale, lease, change or withdrawal without prior notice and approval of owner.





REAL
ESTATE
DEVELOPMENT
PARTNERS

Reedy Creek Nature Preserve



CONTACT

RED Partners

Rob Hord
&
Bobby Edwards
Bobby@redpart.com
(704)909-2484

www.redpart.com

Reedy Creek Nature Center and Preserve

Protects 927 acres of natural, forested habitat

Over 10 miles of hiking and biking trails within
the preserve

Site to be kept natural in perpetuity

Every effort has been made to ensure the accuracy of the information presented but no liability is assumed for errors or omissions. This offering is subject to prior sale, lease, change or withdrawal without prior notice and approval of owner.



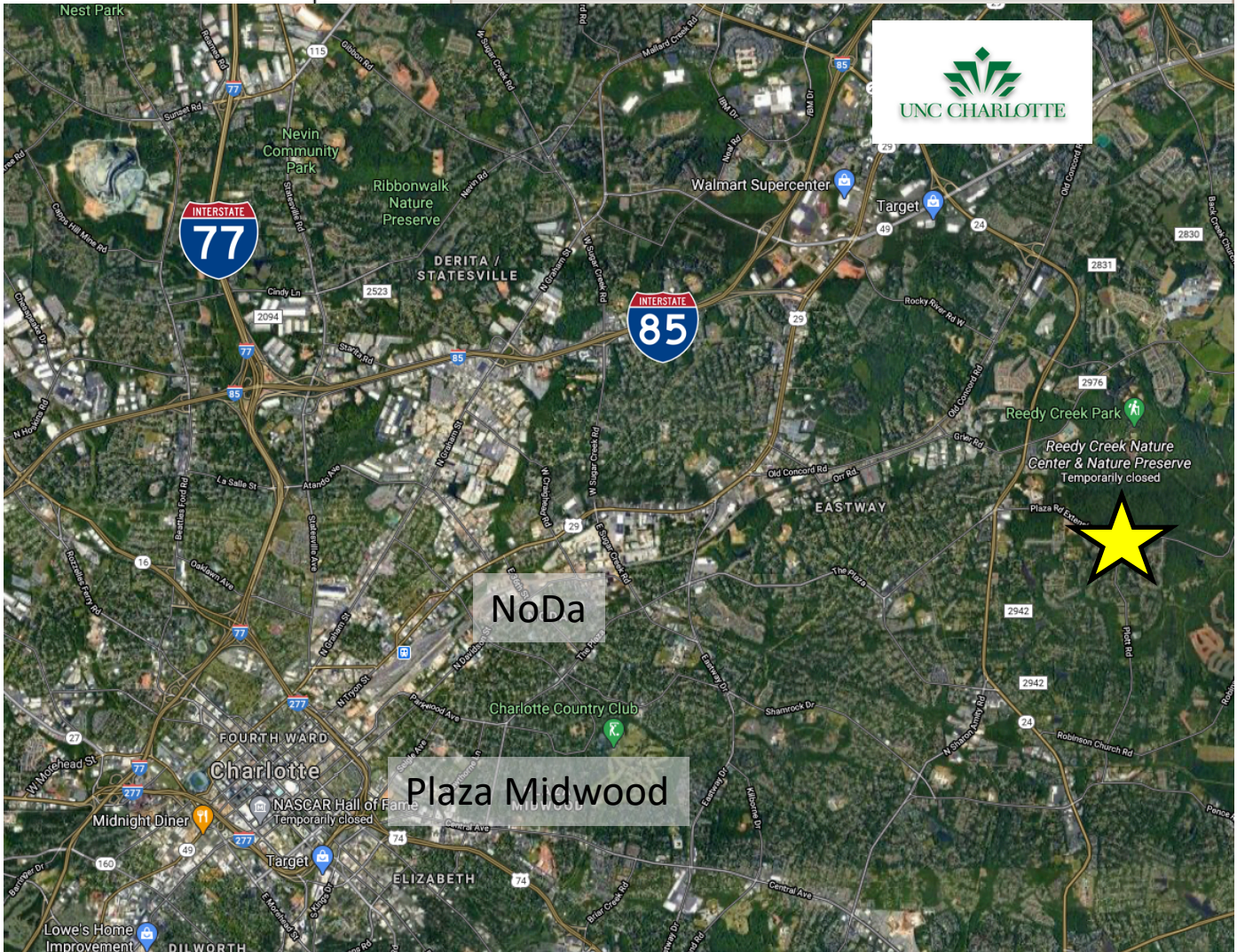

CONTACT

RED Partners

Rob Hord
&
Bobby Edwards
Bobby@redpart.com
(704)909-2484

www.redpart.com

Site Connectivity

Less than 6 miles to UNC Charlotte

4.5 miles to I-485

6 miles to NoDa Neighborhood

7 miles to Plaza Midwood
Neighborhood

9 miles to Uptown Charlotte